



THIN BRICK APPLICATIONS

Precast, Tilt-Up, Prefab Walls and Job Applied



Unique and Distinctive Thin Brick

You're looking at the best thin brick in the industry. Endicott sets the standard for quality and craftsmanship and offers you the most unique colors available today. Our exclusive Ironspot clays create a palette you won't find anywhere else, and our outstanding reputation promises you a product you can depend on – every time.

Endicott thin brick gives you the freedom to dream! That's why you'll find it on some of the most exciting new projects all across the U.S. and Canada.

Thin Brick Cladding Benefits:

- Design freedom
- Lightweight construction
- Quick installation
- Economical in-place cost
- Durability and fire resistance
- Increased insulation value
- All-weather construction

Full brick available in complementary sizes, colors and textures.

Cover: Western Union Headquarters – Philadelphia, PA : Job Applied, Manganese Ironspot





Above: Prudential Center – Newark, NJ : Prefab, Manganese Ironspot, Red Blend

Below: Lucas Oil Stadium – Indianapolis, IN : Precast, Medium Ironspot #77



Thin Brick Applications

Below you'll see some of the more common application processes for thin brick.

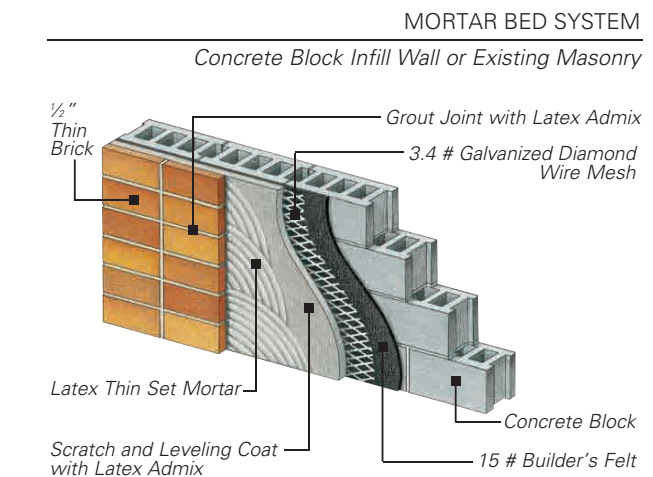
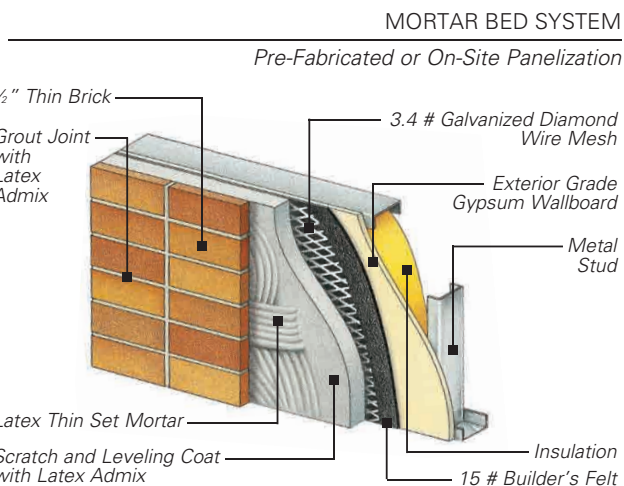
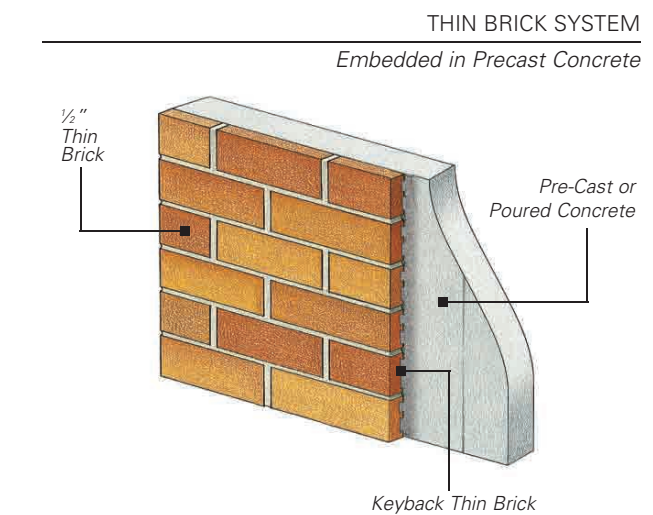
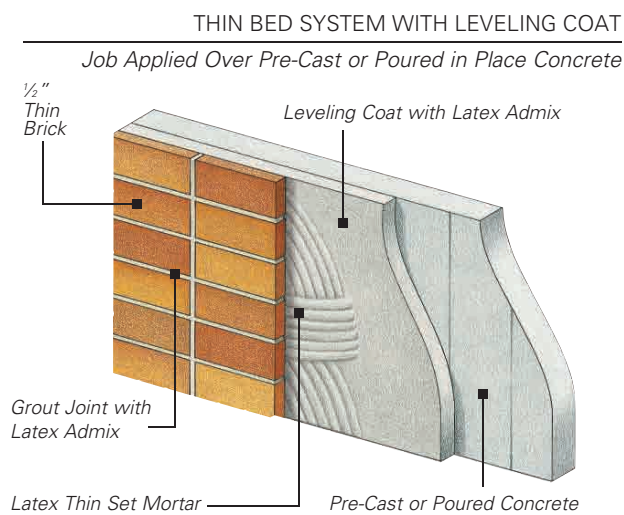
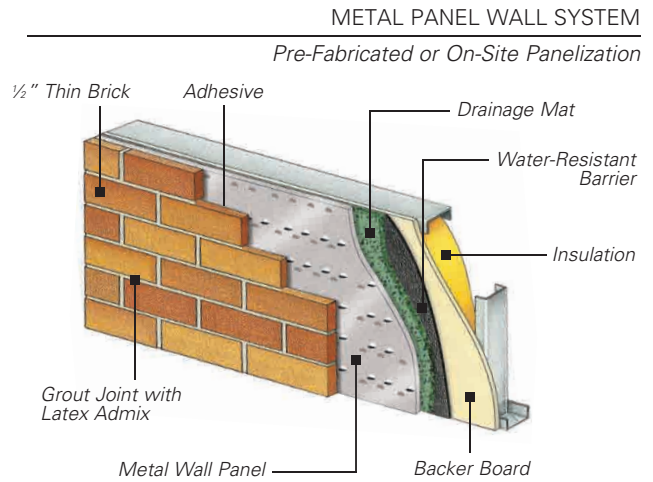
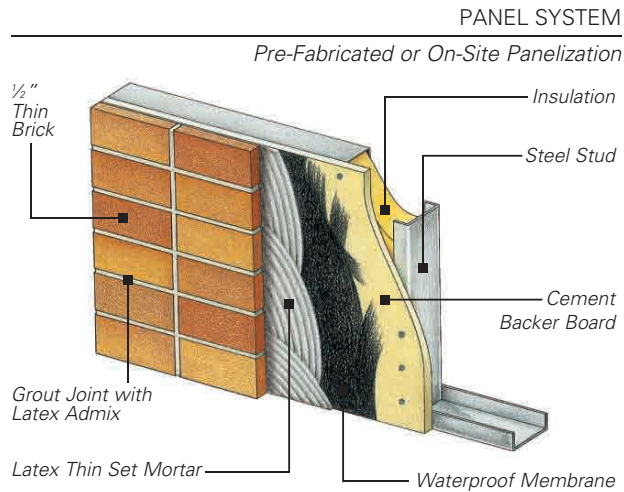



Above: Avera Cancer Center – Sioux Falls, SD : Precast, Custom Blend

Below: The Villages High School – The Villages, FL : Tilt-Up, Autumn Sands



Thin Brick Sizes

To enhance in-place installation, Endicott thin brick feature a distinct keyback design which provides a mechanical lock into the concrete or setting bed for maximum durability and permanence. Endicott also offers waxing for easy cleanup.

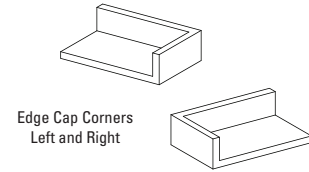

NOTE
Edge Cap – Three-Sided L/R dimensions are the same as the Edge Caps shown here.

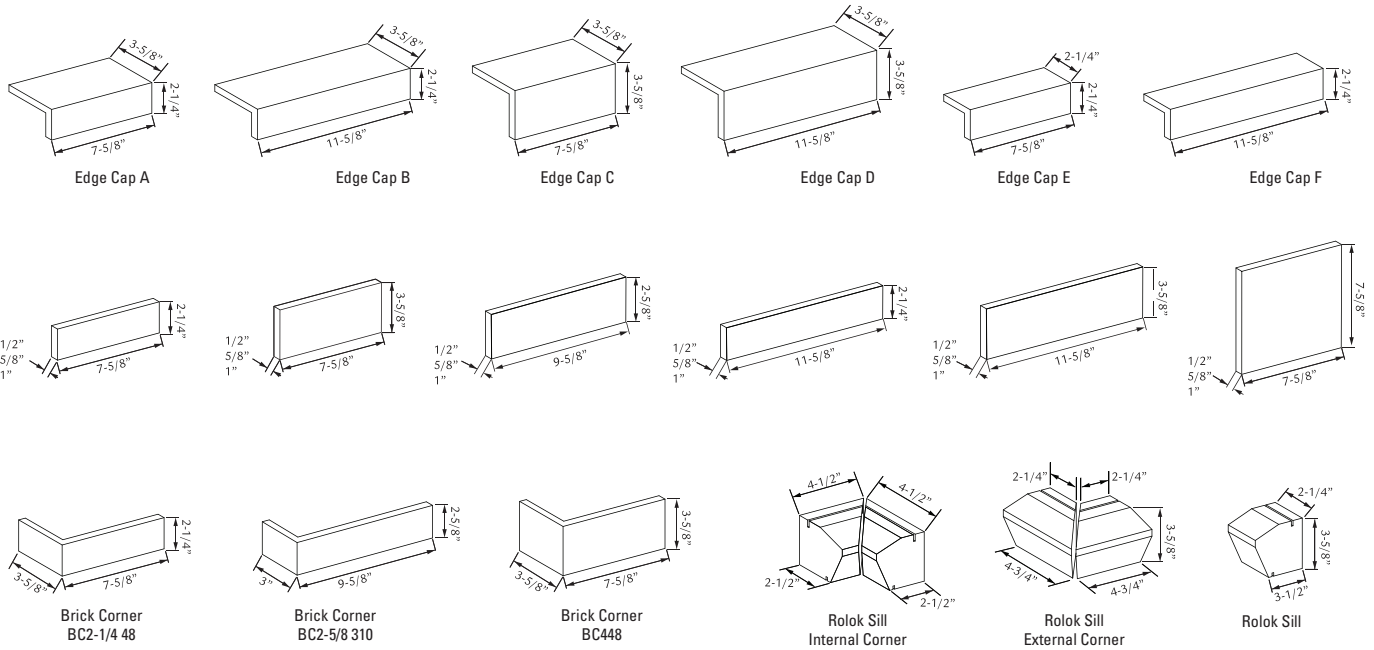

Additional edge cap designs are available upon request.

Estimating Data

2 1/4 x 7 5/8 (Modular)	6.86 pcs./sq. ft.	Brick Corner BC 2-1/4 48	4.50 pcs./lin. ft.
2 1/4 x 11 5/8 (Norman)	4.57 pcs./sq. ft.	Brick Corner BC 2-5/8 310	4.00 pcs./lin. ft.
2 5/8 x 9 5/8 (Kingsize)	4.80 pcs./sq. ft.	Brick Corner BC448	3.00 pcs./lin. ft.
3 5/8 x 7 5/8 (Closure)	4.50 pcs./sq. ft.	Brick Corner BC 2-1/4 412 (1" thickness only)	3.00 pcs./lin. ft.
3 5/8 x 11 5/8 (Utility)	3.00 pcs./sq. ft.	Brick Corner BC 4412 (1" thickness only)	3.00 pcs./lin. ft.

Trim available, contact plant for information.

Specifications

Endicott thin brick is manufactured to meet the requirements of ASTM C1088 Exterior Grade, Type TBX. Endicott thin brick will meet or exceed all requirements and allowances set forth in this industry accepted specification, and have been thoroughly tested. See page 6 for ASTM testing data – additional data available upon request. Endicott thin brick also meet the more stringent tolerances for precast and tilt-up applications.

Testing Data

Brick	Absorption			Efflorescence	Freeze (thru 50 cycles)
	24 hr.		C/B*		
	Cold Water	5 hr. Boil	(Sat. Coeff.)		
Autumn Sands	5.23	7.00	.75	None	Passed
Buff Blend	4.79	6.22	.77	None	Passed
Bourdeaux Blend	5.09	6.64	.77	None	Passed
Burgundy Blend	4.99	6.03	.83*	None	Passed
Burgundy Sands	4.99	6.03	.83*	None	Passed
Coppertone	5.23	7.00	.75	None	Passed
Copper Canyon	6.41	8.28	.77	None	Passed
Dark Ironspot	3.14	3.88	.81*	None	Passed
Dark Sandstone	4.91	7.45	.66	None	Passed
Desert Ironspot (Dark)	4.57	7.17	.64	None	Passed
Desert Ironspot (Light)	5.48	8.19	.67	None	Passed
Desert Sands	5.48	8.19	.67	None	Passed
Executive Ironspot	4.52	7.32	.62	None	Passed
Golden Buff	4.86	7.20	.67	None	Passed
Grey Blend	5.39	7.85	.69	None	Passed
Grey Sands	5.39	7.85	.69	None	Passed
Ivory Blend	3.58	5.53	.65	None	Passed
Light Grey	3.93	5.60	.70	None	Passed
Light Sandstone	4.91	7.45	.66	None	Passed
Manganese Ironspot	2.93	3.59	.82*	None	Passed
Manganese Brown	4.71	5.75	.82*	None	Passed
Medium Ironspot #46	4.67	5.42	.86*	None	Passed
Medium Ironspot #77	5.09	6.57	.77	None	Passed
Merlot Sands	5.09	6.64	.77	None	Passed
Orleans Sands	4.79	6.22	.77	None	Passed
Red Blend	4.99	6.03	.83*	None	Passed
Red Ironspot	4.99	6.03	.83*	None	Passed
Rose Blend	4.79	6.22	.77	None	Passed
Ruby Red	4.99	6.03	.83*	None	Passed
Sahara Sands	5.09	6.57	.77	None	Passed
Sienna Ironspot	4.84	5.62	.86*	None	Passed

*Note: Results are subject to the 24 hour cold water absorption waiver. (at right)



Keyback Design

To enhance in-place installation, Endicott thin brick feature an exclusive keyback design which provides a mechanical lock into the concrete for maximum durability and permanence.

It also provides advantages of increased shear values and pull-out strengths.

Requirements and Allowances of ASTM C1088

Freeze/Thaw (50 cycles)

Requirement for Exterior Grade

No breakage and not greater than .5% loss in dry weight.

Absorption (5 hr Boil)

Exterior Grade

17.0% maximum Average of Five
20.0% maximum Individual

Saturation Coefficient (CB Ratio):

Exterior Grade

.78 maximum Average of Five
.80 maximum Individual

Waiver

If the average 24 hour cold water absorption is less than 8.0%, the requirements for saturation coefficient shall be waived.

Efflorescence

Rating – None

Tolerances on Dimensions

Specified Dimension, inches (mm)	Maximum Permissible Variation from Specified Dimension, ± inches (mm)	
	Type TBX	Type TBS
	3 (76) and under	1/16 (1.6)
Over 3 to 4 (76-102) incl	3/32 (2.4)	1/8 (3.2)
Over 4 to 6 (102-152) incl	1/8 (3.2)	3/16 (4.7)
Over 6 to 8 (152-203) incl	5/32 (4.0)	1/4 (6.4)
Over 8 to 12 (203-305) incl	7/32 (5.6)	5/16 (7.9)
Over 12 to 16 (305-406) incl	9/32 (7.1)	3/8 (9.5)

Tolerances for Type TBA shall be listed in purchase specification.

Tolerances on Distortion

Maximum Face Dimension, inches (mm)	Maximum Permissible Distortion, inches (mm)	
	Type TBX	Type TBS
	8 (203) and under	1/16 (1.6)
Over 8 to 12 (203-305) incl	3/32 (2.4)	1/8 (3.2)
Over 12 to 16 (305-406) incl	1/8 (3.2)	5/32 (4.0)

Tolerances for Type TBA shall be listed in purchase specification.



*Stone Ridge – Fairfield, CT
Job Applied, Coppertone*



Above: Valmont Industries – Omaha, NE : Precast, Desert Ironspot Light

Below: South Dakota State University – Brookings, SD : Precast, Custom Blend



Thin Brick Colors

You won't find these colors anywhere else! Endicott's extensive palette gives you everything – from timeless traditional shades to exclusive Ironspot clays that offer you unique color choices for the ultimate in creative freedom. Endicott thin brick is available in various textures, giving you an endless array of design options.

Talk to us today about samples, or to find your nearest distributor.



*You can request this
Thin Brick Key
from our sample department*

Thin Brick Textures



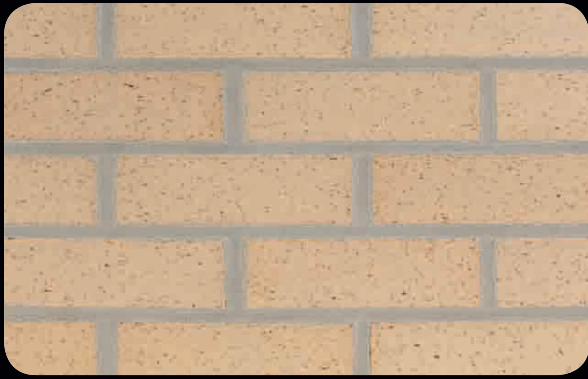

IVORY BLEND – WIRECUT TEXTURE

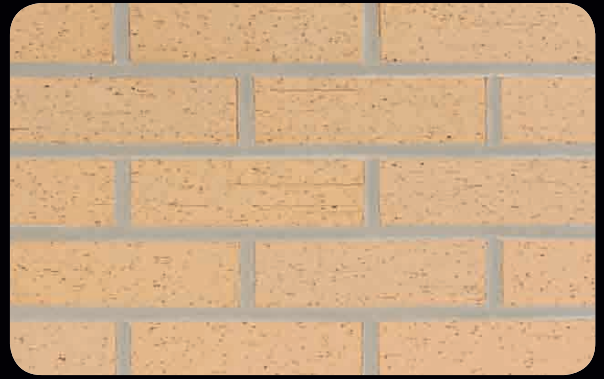

GOLDEN BUFF – WIRECUT TEXTURE

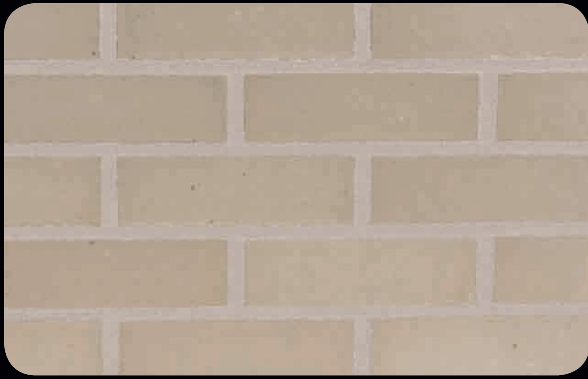

LIGHT GREY BLEND – SMOOTH TEXTURE



GREY BLEND – VELOUR TEXTURE



LIGHT SANDSTONE – VELOUR TEXTURE



DARK SANDSTONE – VELOUR TEXTURE



SIENNA IRONSPOT – SMOOTH TEXTURE



EXECUTIVE IRONSPOT – SMOOTH TEXTURE



BUFF BLEND – VELOUR TEXTURE



ROSE BLEND – VELOUR TEXTURE

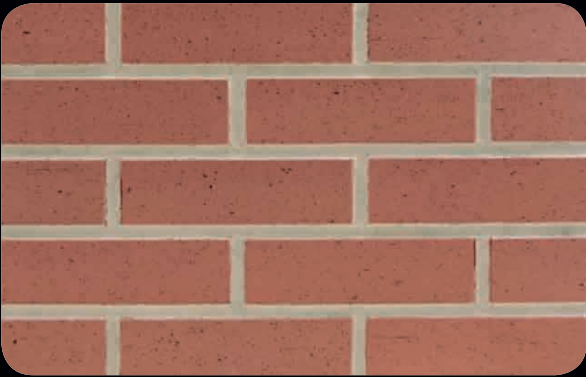

RED BLEND – WIRECUT TEXTURE

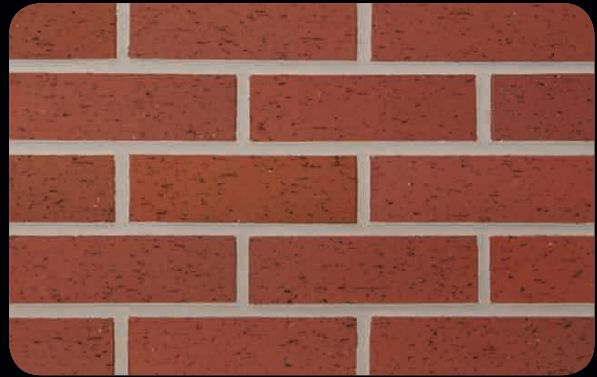

RUBY RED – VELOUR TEXTURE



RED IRONSPOT – WIRECUT TEXTURE



BURGUNDY BLEND – SMOOTH TEXTURE



BORDEAUX BLEND – SMOOTH TEXTURE



MANGANESE BROWN – WIRECUT TEXTURE



DESERT IRONSPOT LIGHT – SMOOTH TEXTURE



DESERT IRONSPOT DARK – SMOOTH TEXTURE



COPPERTONE – VELOUR TEXTURE



COPPER CANYON – VELOUR TEXTURE



MEDIUM IRONSPOT #77 – SMOOTH TEXTURE



MEDIUM IRONSPOT #46 – WIRECUT TEXTURE



DARK IRONSPOT – WIRECUT TEXTURE

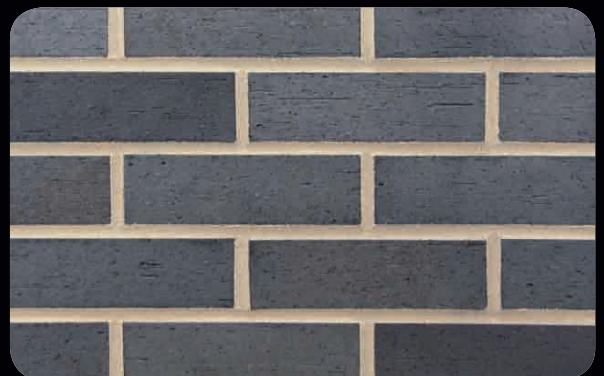

MANGANESE IRONSPOT – WIRECUT TEXTURE



GREY SANDS – SQUARE EDGE/NO TEXTURE



DESERT SANDS – HERITAGE TEXTURE



BURGUNDY SANDS – HERITAGE TEXTURE



MERLOT SANDS – HERITAGE TEXTURE



AUTUMN SANDS – HERITAGE TEXTURE



SAHARA SANDS – SQUARE EDGE/NO TEXTURE



ORLEANS SANDS – HERITAGE TEXTURE

Specify Endicott Thin Brick and Be Amazed

Endicott thin brick is a smart choice. Your imagination will soar.
You won't believe the results!

Specify Endicott thin brick on your next project and take advantage of the limitless opportunities. You can choose from the most unique palette in the industry and realize savings in unit cost and time to build. Endicott thin brick is efficient. Endicott thin brick is beautiful. Let us help you find samples and your nearest distributor and make Endicott thin brick part of your next high-profile project.

*St. Cloud City Hall – St. Cloud, FL
Tilt-Up, Autumn Sands*





Endicott Clay Products Co./Endicott Thin Brick & Tile, LLC – Endicott, Nebraska



Endicott has been building one success story after another all across the U.S. and Canada.

The unique clays found only in Jefferson County, Nebraska, make it possible for Endicott to produce a wide variety of face brick, thin brick, pavers, tile, and special shapes that are nationally recognized for their quality and aesthetic beauty.

Endicott products are distributed throughout the United States and Canada. For literature, samples, BIM models and the name of your nearest distributor contact Endicott today.



Endicott Clay Products Co./Endicott Thin Brick & Tile, LLC
P.O. Box 17
Fairbury, Nebraska USA 68352
PH: 402-729-3315
FAX: 402-729-5804

endicott@endicott.com
endicott.com